

500 N. MICHILLINDA AVENUE > SIERRA MADRE 91024

“THE HOOVER ESTATE”

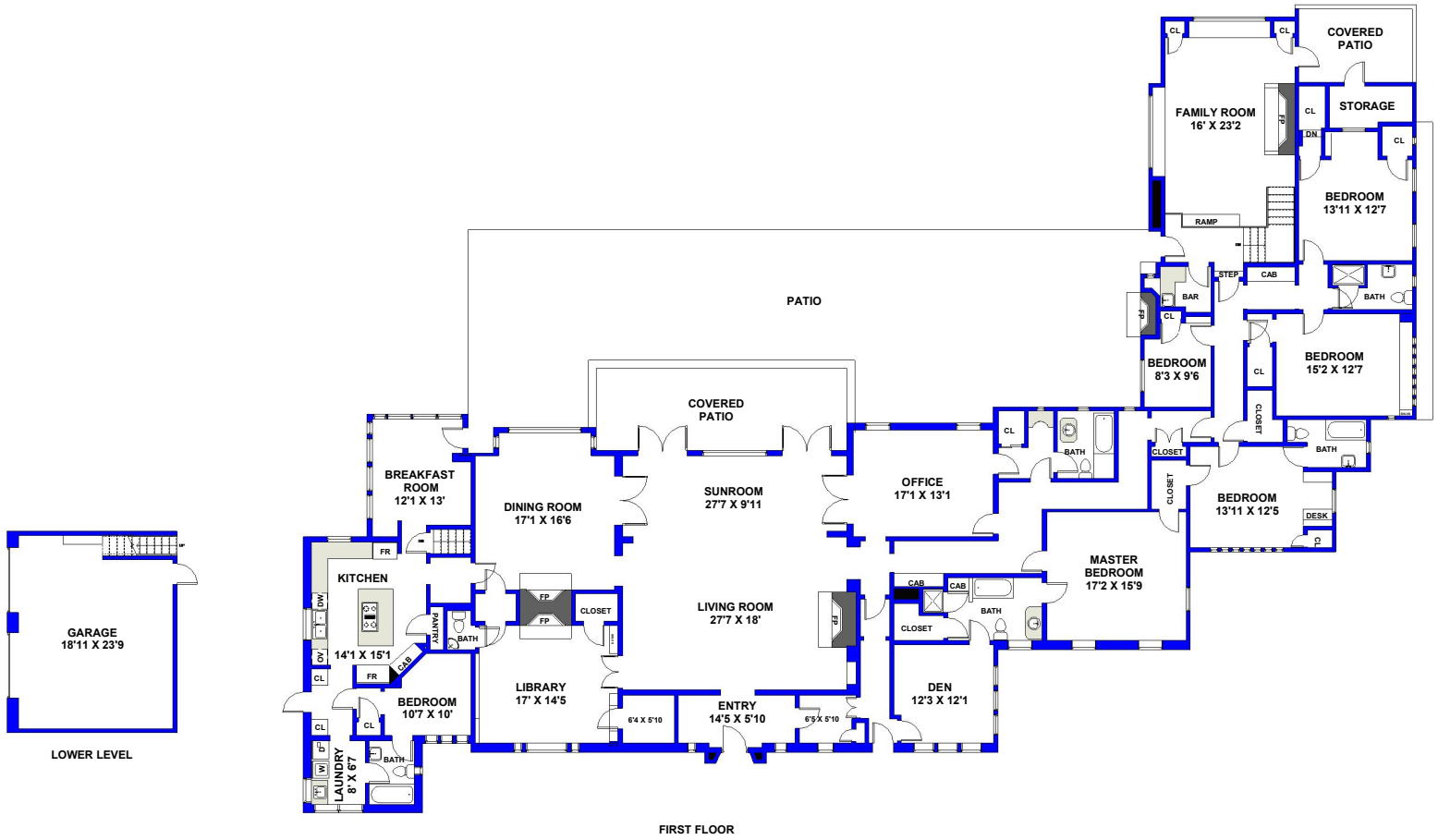

GUEST HOUSE

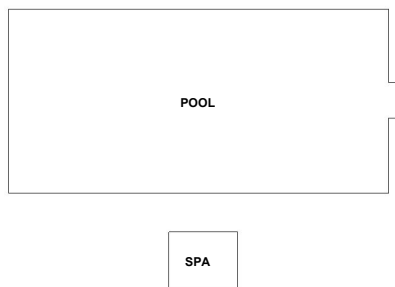

EXCLUSIVELY REPRESENTED BY:

JUDY WEBB-MARTIN

626.688.2273

judywm@podley.com

CalBRE #00541631

30 N. Baldwin Avenue | Sierra Madre 91024

KATIE ORTH

626.688.0418

katyorth@yahoo.com

CalBRE #00942500

FOR MORE INFO: 500NMichillinda.com

Podley Properties® does not guarantee the accuracy of room dimensions, square footage, lot size, or other information regarding the condition or features of the property provided by the seller or obtained from public records or other sources. Buyer is advised to verify that information through personal inspection with the appropriate professionals. Floorplan by R.E.S.T. 626-840-1717. Information deemed reliable but not guaranteed. Equal Housing Opportunity. ©2017 Podley Properties. All rights reserved. Marketing materials produced by Podley Studio.

